

## SEAL KIT FOR STAINLESS STEEL VALVES, ACTUATOR Ø 63/90

Maintenance operations must be carried out by qualified personnel according to manufacturer's instructions.  
To replace seals, please refer to the instruction manual provided with the valve.

**Normally Closed**

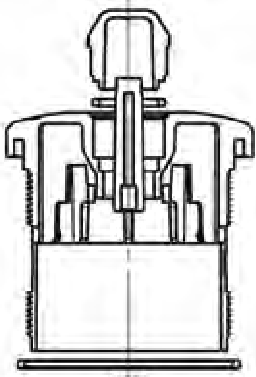

**Normally Open**

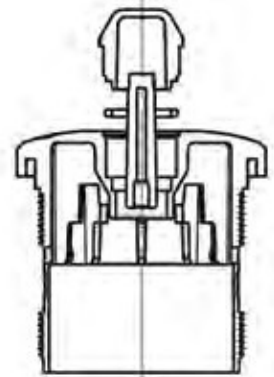

### SPARE PARTS KIT:

Lip seal, o-rings, main seal, body seal

Kit code	DN	Valve type ♦	Actuator		
856 11100-	15	PG/RPG/BPG-PN/RPN/BPN-PW/RPW/BPW-PB/RPB/BPB-PD/RPD/BPD-PA/BPA/RPA-PC/RPC/BPC-PP/RPP/BPP-PR/RPR/BPR-High temPerature version	Ø 63		
856 12200-	20				
856 13300-	25				
856 14400-	32				
856 15500-	40				
856 166 00-	50				
856 611 00-	15			DPG/DPN-	Ø 63
856 622 00-	20				
856 633 00-	25				
856 644 00-	32				
856 655 00-	40				
856 666 00-	50	PG/RPG/BPG-PN/RPN/BPN-PW/RPW/BPW-PB/RPB/BPB-PD/RPD/BPD-PA/BPA/RPA-PC/RPC/BPC-PP/RPP/BPP-PR/RPR/BPR-High temPerature version	Ø 90		
856 313 00-	25				
856 314 00-	32				
856 315 00-	40				
856 316 00-	50				

### STEM SEALS KIT

Kit code	DN	Valve type ♦	Actuator
856 80200-	all	PG/RPG/BPG/DPG-PN/RPN/BPN/DPN-PW/RPW/BPW-PB/RPB/BPB-PD/RPD/BPD-PA/BPA/RPA-PC/RPC/BPC-PP/RPP/BPP-PR/RPR/BPR-	Ø 63/90
856 90000-	15	High temPerature version	Ø 63
856 90100-	20		
856 90200-	25		
856 90300-	32	High temPerature version	Ø 90
856 90400-	40		
856 90500-	50		

♦ Included versions with optional: stroke regulator (e.g. code PW208STZR0) and travel switch version (e.g. code BPG209LTKI0)

## SEAL KIT FOR STAINLESS STEEL VALVES, ACTUATOR Ø 45

Maintenance operations must be carried out by qualified personnel according to manufacturer's instructions.  
To replace seals, please refer to the instruction manual provided with the valve.

**Normally Closed**

**Normally Open**

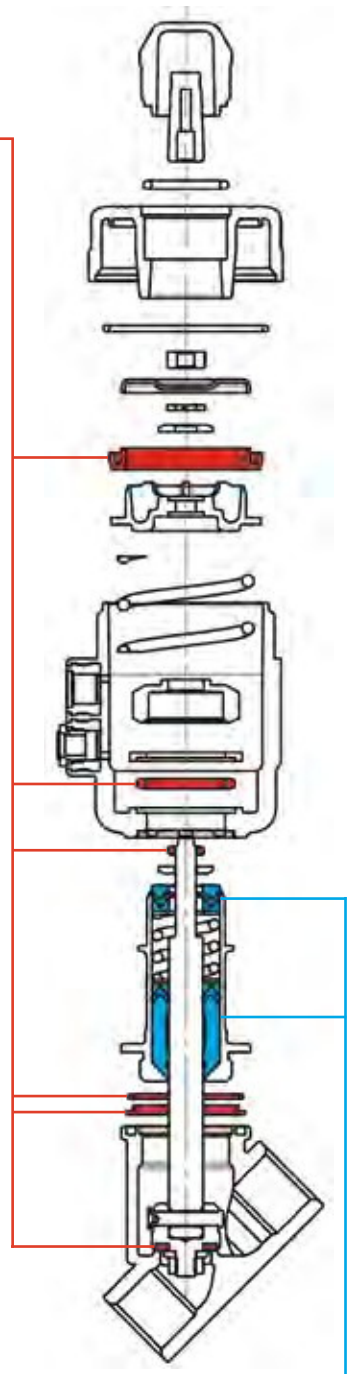
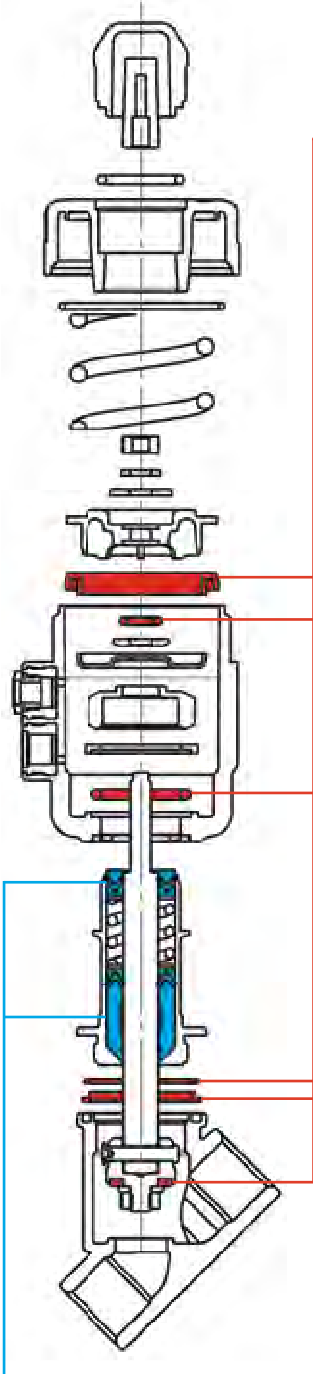

SPAREPARTS KIT: Lip seal, o-rings, main seal, body seal			
Kit code	DN	Valvetype	Actuator
856 011 00-	15	PG/RPG/BPG- PN/RPN/BPN- PW/RPW/BPW- PB/RPB/BPB-	Ø 45
856 012 00-	20	PC/RPC/BPC- PP/RPP/BPP-	
856 013 00-	15	PR/RPR/BPR	
856 014 00-	20	DPG/DPN-	

STEM SEALS KIT			
Kit code	DN	Valvetype	Actuator
856 801 00-	all	all	Ø 45

## SEAL KIT FOR BRONZE VALVES, ACTUATOR Ø 63/90

Maintenance operations must be carried out by qualified personnel according to manufacturer's instructions.  
To replace seals, please refer to the instruction manual provided with the valve.

**Normally Closed**

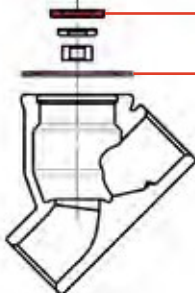
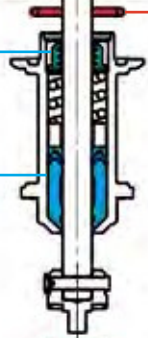
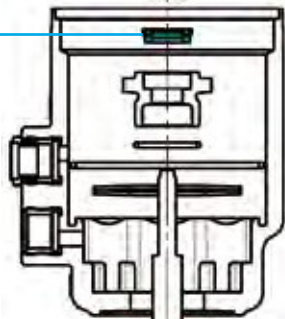
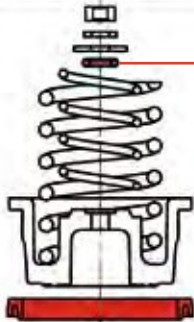
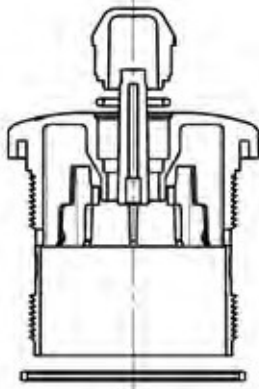

**Normally Open**

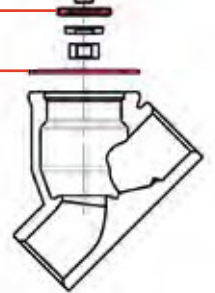
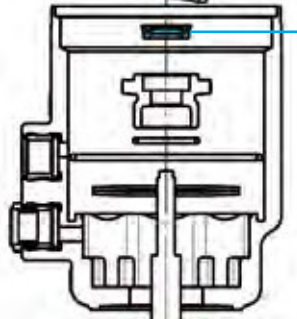
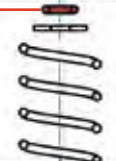
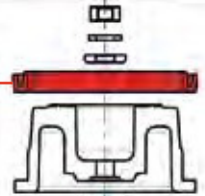
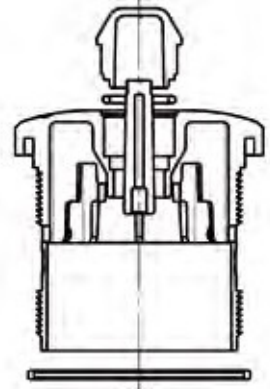

### SPAREPARTS KIT:

Lip seal, o-rings, main seal, flat seal

Kit code	DN	Valve type ♦	Actuator
856 11200-	15	CG/RCG/BCG- CN/RCN/BCN-	Ø 63
856 12300-	20		
856 13400-	25		
856 14500-	32		
856 15600-	40		
856 16700-	50	DCG/DCN-	Ø 63
856 61200-	15		
856 62300-	20		
856 63400-	25		
856 64500-	32		
856 65600-	40	CG/RCG/BCG- CN/RCN/BCN-	Ø 90
856 66700-	50		
856 31700-	25		
856 31800-	32		
856 31900-	40	CG/RCG/BCG- CN/RCN/BCN-	Ø 90
856 32000-	50		

### STEM SEALS KIT

Kit code	DN	Valve type ♦	Actuator
856 802 00-	all	CG/RCG/BCG-/DCG- CN/RCN/BCN/DCN-	Ø 63/90

♦ Included versions with optional: stroke regulator (e.g. code CG206STXR0) and travel switch version (e.g. code BCG210LTJ0)

## SEAL KIT FOR BRONZE VALVES, ACTUATOR Ø 45

Maintenance operations must be carried out by qualified personnel according to manufacturer's instructions.  
To replace seals, please refer to the instruction manual provided with the valve.

### Normally Closed

### Normally Open

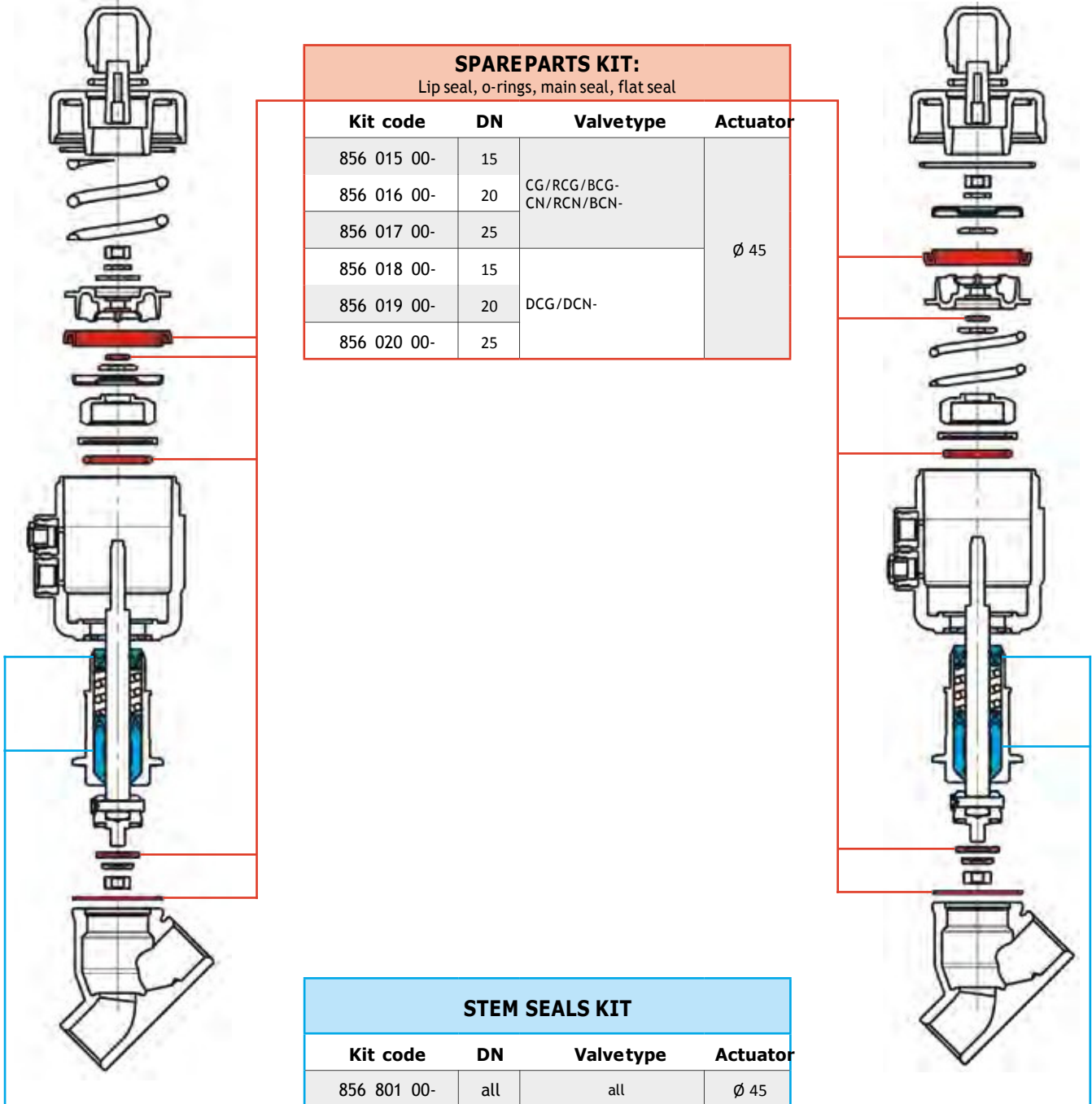

SPAREPARTS KIT: Lip seal, o-rings, main seal, flat seal			
Kit code	DN	Valvetype	Actuator
856 015 00-	15	CG/RCG/BCG- CN/RCN/BCN-	Ø 45
856 016 00-	20		
856 017 00-	25		
856 018 00-	15	DCG/DCN-	
856 019 00-	20		
856 020 00-	25		

STEM SEALS KIT			
Kit code	DN	Valvetype	Actuator
856 801 00-	all	all	Ø 45